

# Intel® Server Chassis SR1300 Quick Start User Guide

## Start Here

Thank you for buying an Intel® Server Chassis. The following information will help you prepare your server chassis for integration with your selected server board.

This Guide is for technically qualified persons. Expanded installation instructions and complete product information are available in the *Product Guide* on the Chassis Documentation CD. Spanish and Simplified Chinese translations of the *Product Guide* are also available at the Web site listed at the bottom of this box. For more information on using the features of your server chassis, see the Configuration Quick Reference Label inside the chassis cover and your *Product Guide*.

### Before you begin

You will need the following tools and equipment:

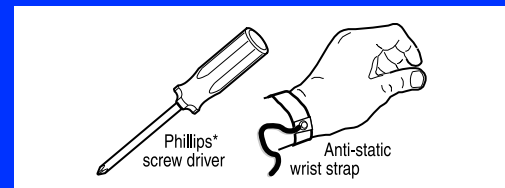

See your *Product Guide* for product Safety and EMC regulatory compliance information.

If you are not familiar with ESD (Electro-Static Discharge) Procedures to be used during system assembly, complete ESD Procedures are described in your *Product Guide*.

Additional resources and support for your server chassis can be found at:  
<http://support.intel.com/support/motherboards/server/chassis/SR1300>

## Build Value with Intel

**Server Products, Programs and Support**  
 Get the high-value server solutions you need by taking advantage of the outstanding value Intel provides to system integrators:

- High-quality server building blocks
- Extensive breadth of server building blocks
- Solutions and tools to enable e-Business
- Intel® Server Management
- Comprehensive training services†
- Worldwide 24x7 technical support (AT&T Country Code + 866-655-6565)†
- World-class service, including a three-year limited warranty and Advanced Warranty Replacement†

For more information on Intel's added-value server offerings, visit the Intel® ServerBuilder website at: [www.intel.com/go/serverbuilder](http://www.intel.com/go/serverbuilder)

Intel ServerBuilder is your one-stop shop for information about all of Intel's Server Building Blocks such as:

- Product information including product briefs and technical product specifications
- Sales tools such as videos and presentations
- Configurator Tools to help you build complete solutions
- Training information such as the Intel® Online Learning Center
- Support Information and much more

†Available only to Intel® Channel Program Members, part of Intel® e-Business Network.

## 1 Removing the Top Cover

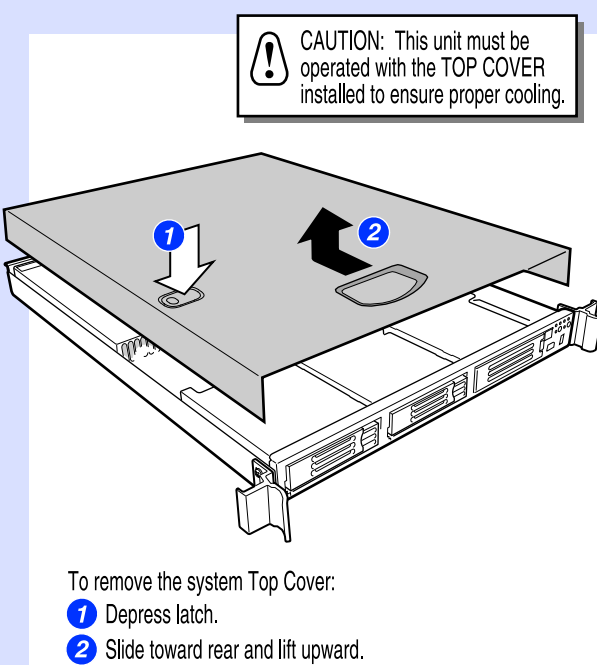

To remove the system Top Cover:  
 1 Depress latch.  
 2 Slide toward rear and lift upward.

## 2 Removing Add-in Card Risers

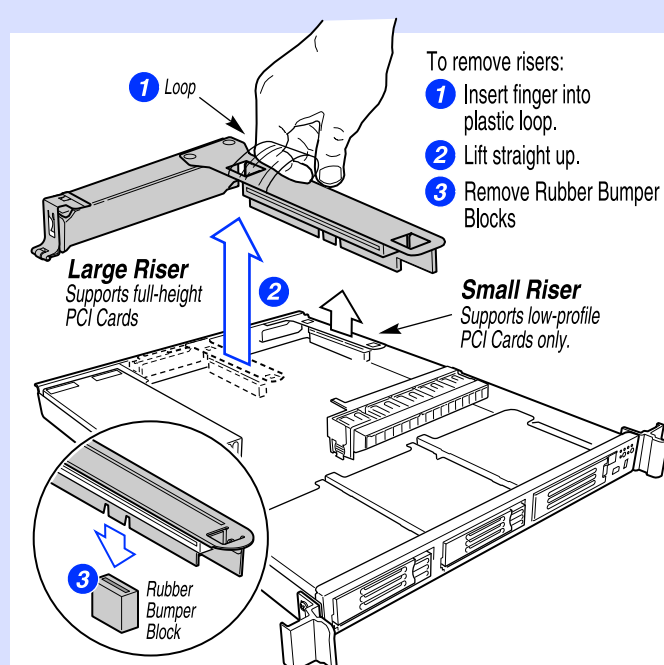

### Fastener Identification Guide

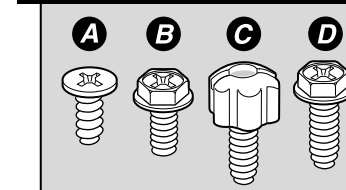

## 3 Removing the Fan Module

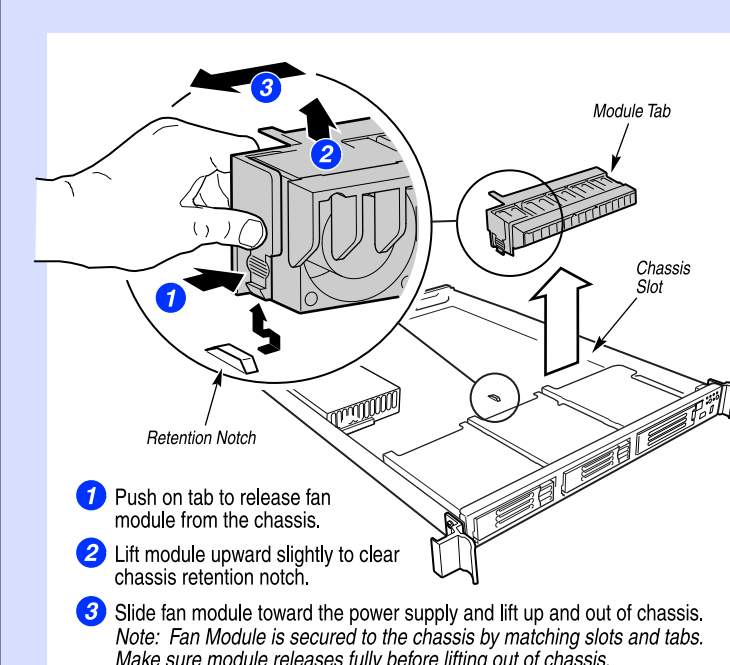

## 4 Removing the Power Supply

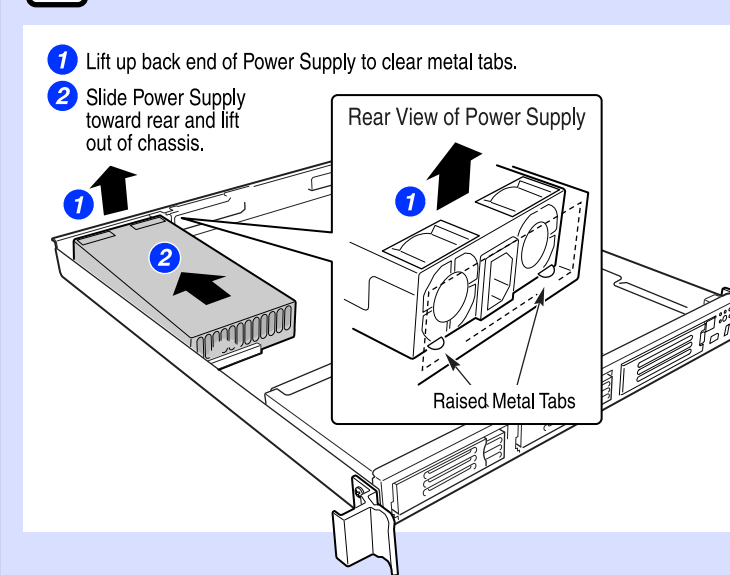

## 5 Removing the Drive Carriers

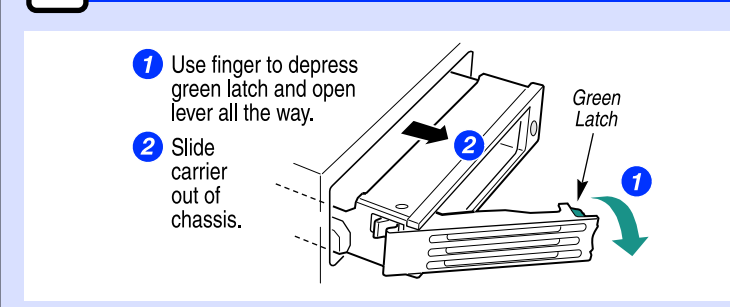

## 6 Installing the Power Distribution Board

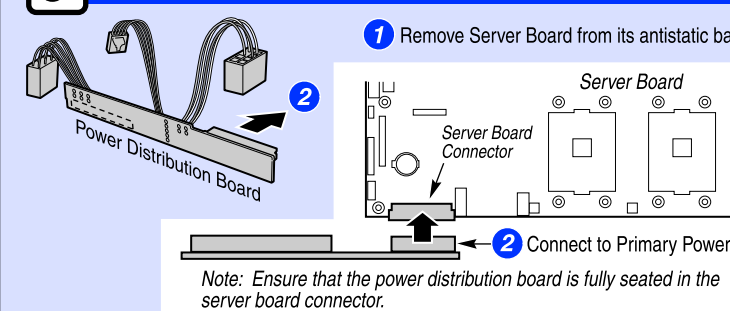

## 7 Installing the Server Board

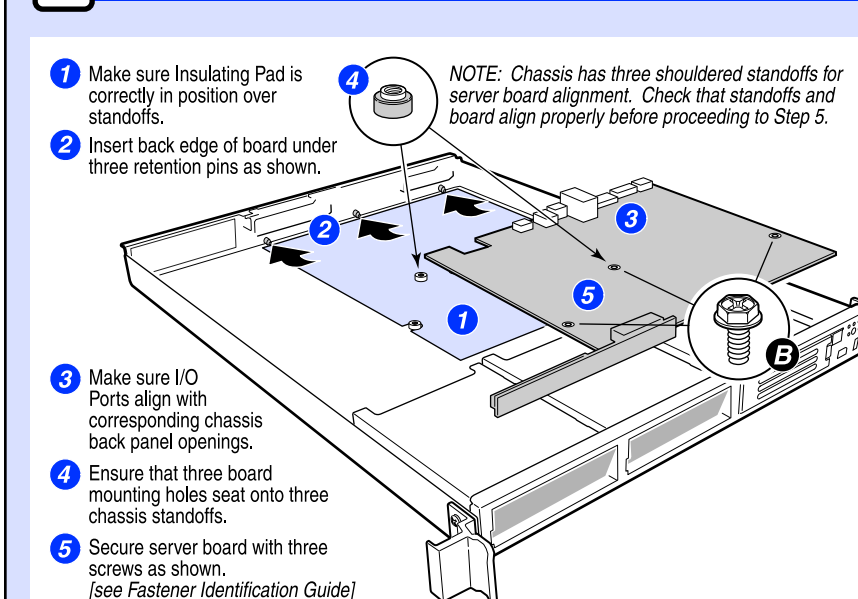

## Go to SIDE 2

## 12 Install and Route Cables

### A Install Front Panel-to-Backplane Data Cable

Install Front Panel Data Cable as shown. Both cable ends are identical.

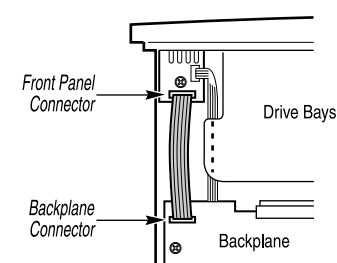

### B Install Power and Data Cables ...

Connect cables as shown beginning with Step #1:

- 1 Install Floppy/FP/IDE Flex Cable as shown. Note that placement is under the Aux. Power cables.
- 2 Attach Auxiliary Signal Cable to Server Board connector.
- 3 Attach Backplane Power Cable to Backplane Board.
- 4 Attach Auxiliary Power Cable to Server Board connector.

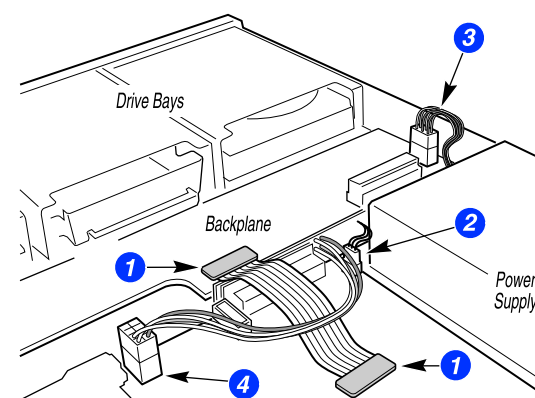

### C Attach Drive Cables

#### SCSI System

- 1 Connect to Server Board at J7B1.
- 2 Route SCSI Cable as shown between the PCI Riser and the Memory DIMMs.
- 3 Connect to Backplane SCSI connector.

#### ATA System

- 1 Connect Secondary ATA-100 Cable first.
- 2 Connect Primary ATA-100 Cable last.

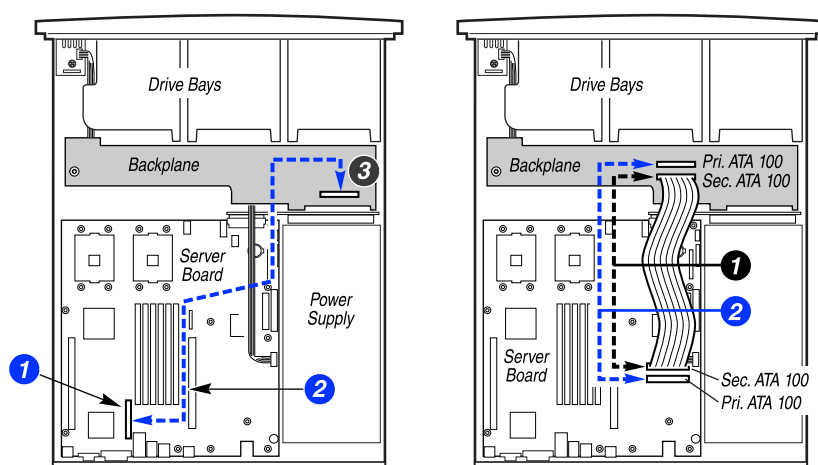

**WARNING:** Installation and service of this product to be performed only by qualified service personnel to avoid risk of injury from electrical shock or energy hazard.

See Server System Product Guide for detailed service descriptions and procedures.

## 10 Installing USB Cable and Backplane Board

- 1 Position USB Ribbon Cable as shown.
- 2 Connect USB Cable from Front Panel Board to Server Board.
- 3 Place Backplane as shown. Tilt the backplane downward to clear the pins on the power distribution board. Note that USB Cable is underneath the backplane.
- 4 Align Backplane mounting holes over Locking Pins and slide to left to lock.
- 5 Secure backplane with plastic Thumbscrew.

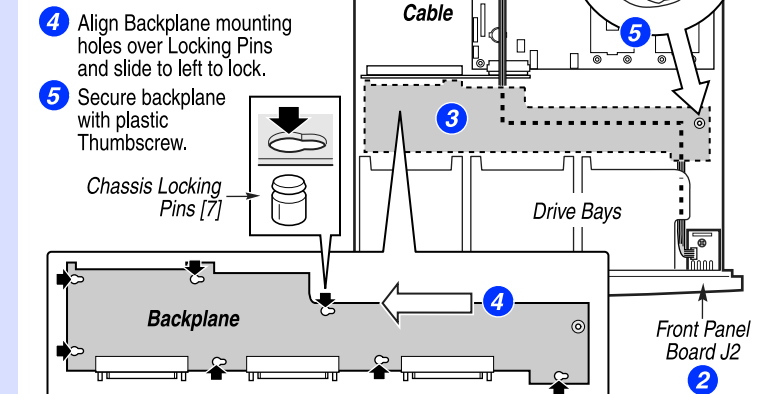

## 11 Install the Power Supply

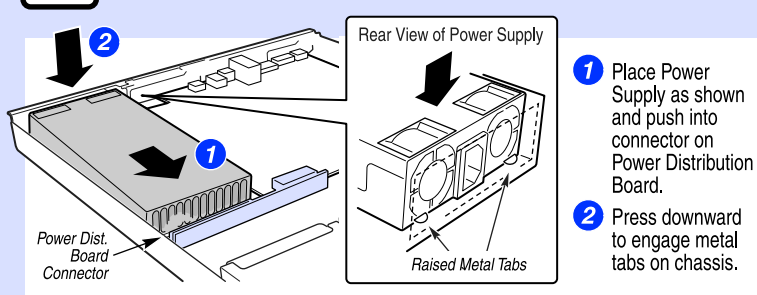

## 8 Install Processors/Heat Sinks/Memory

Go to Server Board Quick Start User's Guide and install Processor(s), Heat Sink(s) and Memory.

## 9 Install Processor Socket 2 Air Dam

If you have installed only ONE processor, complete this step to maintain proper system airflow. If you have installed two processors, skip this step.

### A Install the Processor Retention Devices

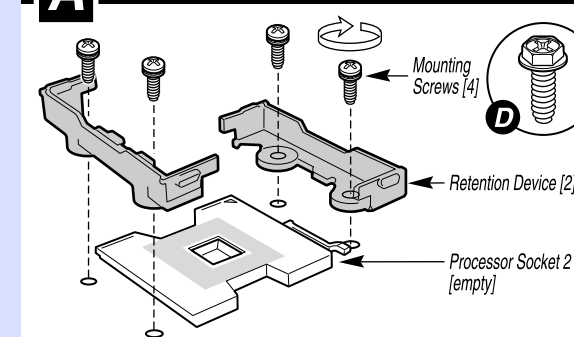

### B Install the Air Dam

- 1 Install Air Dam by inserting into retention devices as shown.
- 2 Insert Tabs on Air Dam under sides of retention device. Note that Air Dam bends upward when installed correctly.

See Reference diagram for Socket 2 location.

