

LisaDraw is a unique graphics presentation tool that makes it easy to create flow charts, technical diagrams, maps, pictures, and symbols for reports and presentations. Creating lines, boxes, circles, and other geometrical shapes is as easy as moving the mouse along a tabletop. Combining these shapes lets you be as creative as you like. And adding text is elementary.

With LisaDraw you can save any creation for repeated use in other LisaDraw documents. Moreover, you can easily move LisaProject schedules and LisaGraph charts and graphs into LisaDraw for customization.

In less than 30 minutes you'll be doing useful work with LisaDraw. Lisa's revolutionary Graphics

Mouse Technology™ replaces confusing computer commands with simple graphic images. Graphics, together with the mouse, a simple selecting device, let you create, revise, and print documents intuitively. And because basic operations work the same way in all Lisa™ applications, you'll learn other applications in even less time.

**LisaDraw uses the power and flexibility of Lisa to give you capabilities far beyond those of virtually any other graphics program. With the ability to express your ideas visually — through high-quality graphics — you'll communicate more easily and effectively.**

**A picture is worth a thousand words.**

- LisaDraw's lines, boxes, and text let you illustrate complex aspects of your business with flow charts.
- Create and revise drawings for presentations, training manuals, reports, sales curves, sketches, and more.

**Work with graphics as easily as with text.**

- Drawing lines, boxes, circles, and other common shapes takes just two simple moves of the mouse.
- Changing lines and shapes, or moving them, is done with the mouse. There are no commands to remember.

Except for generating text, everything created in **LisaDraw** is done with the mouse. Use it to select from the palette the shape you'd like to draw; the pointer then draws figures of that shape. To add text, simply select the TEXT box from the palette. As in other Lisa applications, you can also use the mouse to select items from the menu bar.

**Menu Bar** All LisaDraw functions are selected from the menu bar. To print a document, for example, just move the mouse and select PRINT from the menu. Once printing is under way, you may continue working with Lisa, either in the same document, or in another application.

**Mouse/Pointer** The mouse is a palm-size device that controls Lisa's pointer. It replaces all confusing special function keys and commands. The mouse is connected to Lisa by a thin cable. When you move the mouse, Lisa's pointer matches the movement on the screen.

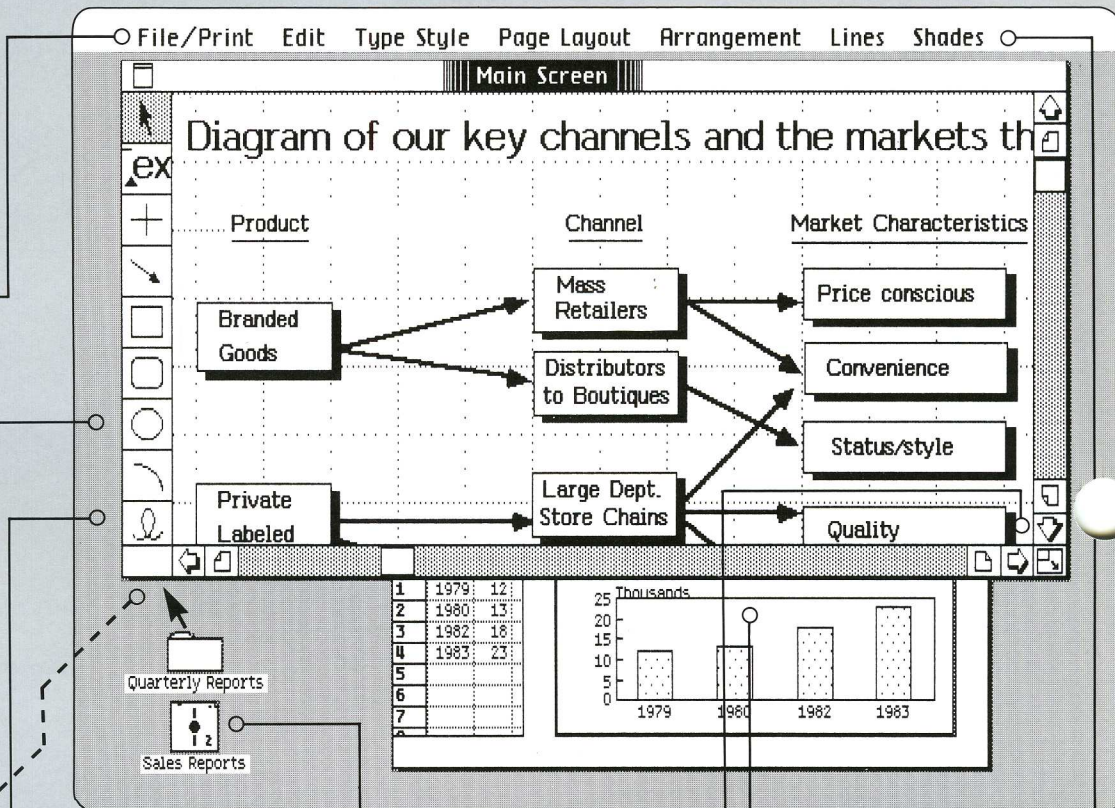
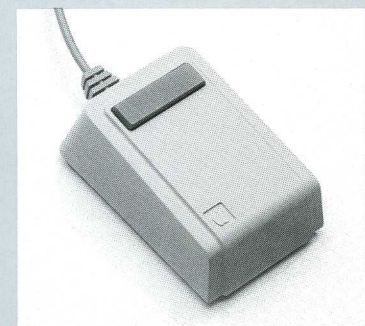

**Drawing Freestyle** Use this option for freestyle drawings. Anywhere you move the cursor, the line follows. And you can even "smooth" it to take the kinks out.

**Drawing Circles** To draw perfectly rounded circles, use the mouse to select the circle from the palette; moving the mouse will then draw circles on the screen.

**Desktop Manager** The Desktop Manager uses graphic symbols such as these to coordinate all the system's operations. For example, to work on a document, simply use the mouse to select an existing document or create a new one. When you're finished, use the mouse to put the document into a folder. The Desktop Manager also enables you to work with more than one document at a time.

**Scrolling** To view another part of your LisaDraw document, simply use the mouse to select the arrows in the corners of the document. Similarly, to stretch or contract the document, use the mouse to move the box at the bottom right-hand corner.

**Shades Menu** Once you have the shapes you want, fill them in with your choice of 36 different patterns.

**LisaGraph** More than one Lisa document may be on the screen at one time. To move information from LisaGraph to LisaDraw, for example, simply use the mouse to select COPY from the EDIT menu. When you're ready to transfer the information into the LisaDraw document, select PASTE and your data is transferred — you don't even have to touch the keyboard.

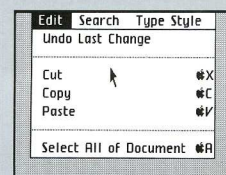

- You get instant feedback on everything you do—there's no waiting to see the results. This makes it easy to create a picture diagram that's just the size and shape you want.

**What you see on the screen is exactly what you get on the printed page.**

- Choose from four different sizes and three styles of text, all of which can be displayed and printed in bold, italic, underlined, or shadow—or any combination.
- Apple's high-resolution Dot Matrix and Daisy Wheel Printers both produce unsurpassed graphics and text suitable for reports or for copying onto overhead transparencies.

**The way a business works can be complex—LisaDraw helps you get a handle on it.**

- Different shapes and shadings can represent kinds of activities, processes, or systems; and arrows show interdependencies.
- Organization charts and floor plans are easy; the optional grid helps you align objects perfectly.
- Add text anywhere, at any time.
- LisaDraw can accommodate illustrations up to 60 pages.

**Use LisaDraw to customize charts and graphs from other applications.**

- Moving a LisaGraph or Lisa-Project chart into LisaDraw is quick and easy.
- Revise any graph or chart. Change sizes, shapes, patterns, and locations of bars, pies, lines, and titles.

LisaDraw is a revolutionary tool. It enables you to draw lines, circles, boxes, and any other geometrical shapes. It also lets you add text to your drawings.

However, the real beauty of LisaDraw is using it to customize reports, memos, presentations—anything that you want to look good—with professional-quality graphics. And you can do it all at your desk, using only the mouse and the keyboard.

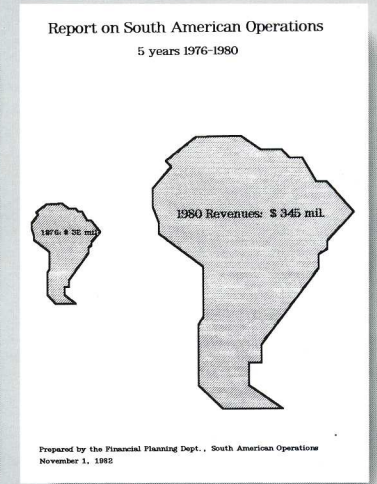
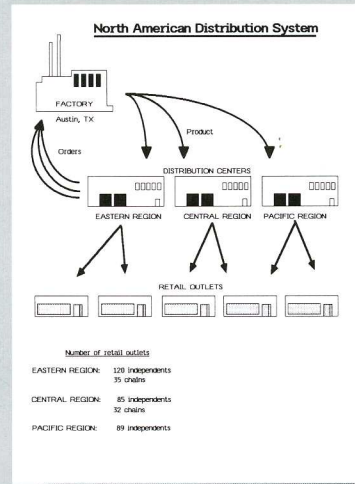
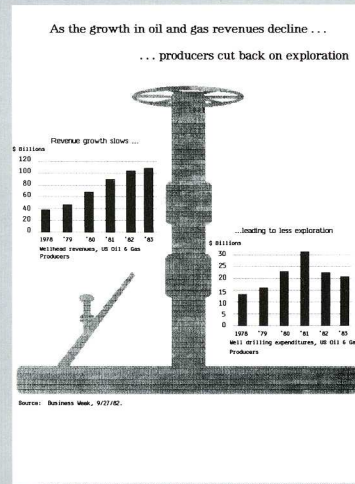
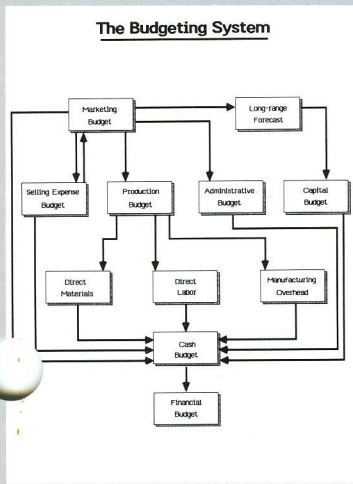

Create professional-quality diagrams, which can then be made into transparencies for sales, marketing, and other presentations.

Add dramatic impact to your business charts or graphs.

Illustrate interdependencies among jobs or projects, or draw schematic drawings.

Illustrate important geographic information with maps or regional drawings.

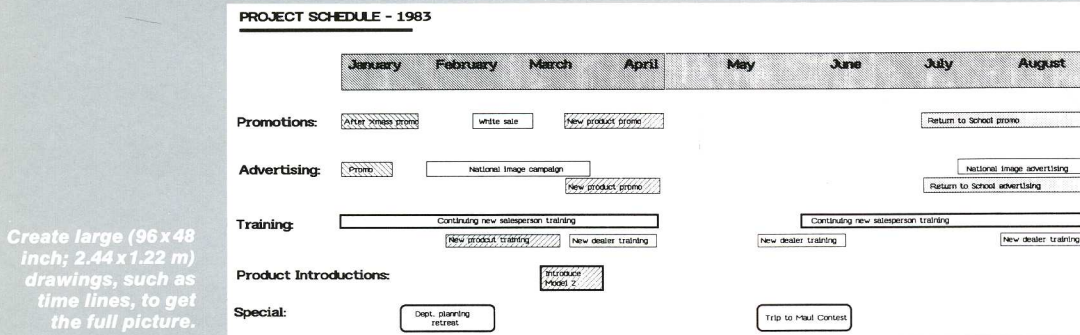

Create large (96 x 48 inch; 2.44 x 1.22 m) drawings, such as time lines, to get the full picture.

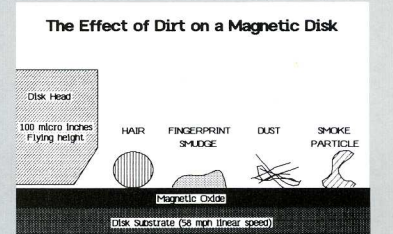

Create simple illustrations to help describe complex situations.

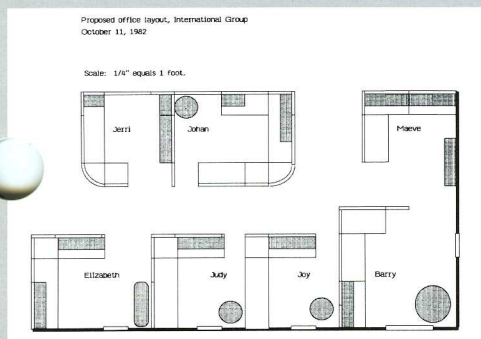

Create organization charts that can be saved and updated when the staff changes.

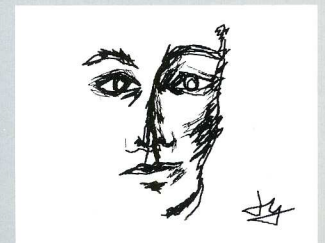
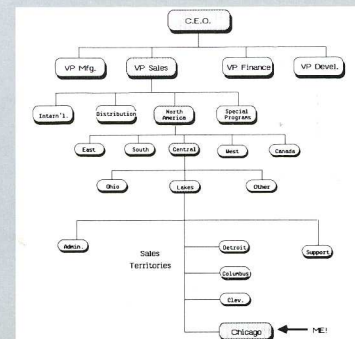

Create sketches and original artwork as you would by hand.

**Basic learning time:**

- Less than 30 minutes.

**Maximum drawing size:**

- 32 square feet (2.9 square meters) (about 60 pages).

**Drawing:**

- Palette selections:
  - squares and rectangles (with and without rounded corners).
  - circles and ellipses.
  - horizontal, vertical, and diagonal lines.
  - arcs.
  - polygons (including triangles).
  - freehand curves.
- 36 patterns for filling shapes.
- Four line thicknesses (fine, narrow, medium, wide).
- Three line shades (black, grey, white).
- Lines can have arrowheads at one or both ends.

**Graphic editing:**

- Combine more than one existing LisaDraw document.
- Move any object or shape.
- Place objects in front of or behind others.
- Shrink or expand any object yet maintain its shape.
- Reshape freehand curves, arcs, and polygons.
- Automatically smooth curves.
- Copy or delete any object.
- Change line thickness or line shade.
- Change pattern of shading inside a shape or object.
- Group shapes or objects to move, copy, or delete them together.

**Text editing:**

- Add text to any part of drawing
  - just point with mouse and type.
  - edit just as you would with LisaWrite.
- Functions available:
  - cut and paste.
  - copy and move.
  - delete.
  - change typesyles.

**Alignment aids:**

- Grids displayable on screen in various sizes.
- Rulers displayable on screen
  - horizontal and vertical.
  - marked in inches, centimeters, or in user-defined increments.
- Align edges of objects.
- Measure distance between two points and the size of objects.

**Typesyles:**

- A variety of typesyles, including large presentation sizes (1/4–1/3-inch; 6.35 x 8.47 mm tall).
- Proportionally spaced styles.
- Type can be bold, italic, shadow, hollow, underlined, or any combination.

**Special features:**

- Move LisaGraph and LisaProject charts into LisaDraw for further customization quickly and easily, without touching the keyboard.
- LOCK allows you to protect creations from accidental editing.
- UNDO function cancels effects of last operation.
- REVERT TO PREVIOUS VERSION undoes all changes made to the document since it was last saved.
- Horizontal and vertical scrolling.

**Printing:**

- “What you see is exactly what you get” fidelity.
- Automatic page breaks.
- Apple's high-resolution Dot Matrix Printer (160 x 144 dots per inch; 6.2 x 5.6 dots per mm).
- Apple's Daisy Wheel Printer.
- Paper can be 8½ x 11 (215 x 279), 8½ x 14 (215 x 355), or 11 x 14 (279 x 355 mm) inches.
- Print one or multiple copies.
- Print whole drawing or selected pages.
- Print in horizontal or vertical formats.

**Documentation:**

- Brief orientation guide to get you started in less than 30 minutes.
- Complete reference guide.
- Extensive step-by-step tutorial.
- Handy reference card.

**Apple/U.S.**

Apple Computer, Inc.  
20525 Mariani Avenue  
Cupertino, California 95014  
(408) 996-1010  
TLX 171-576

**Apple/U.K.**

Apple Computer (U.K.) Ltd.  
Eastman Way  
Hemel Hempstead  
Herts HP2 7HQ  
England  
011-44-442-60244  
TLX 851-825834

**Apple/Europe**

Apple Computer International  
5/7 rue de Chartres  
92200 Neuilly-sur-Seine  
France  
011-33-1-624-21-13  
TLX 842-630296

**Apple/Canada**

Apple Canada  
875 Don Mills Road  
Don Mills  
Ontario, Canada M3C 1V9  
(416) 444-2531  
800-268-7637  
TLX 06-986561