

ATTACHMATE. HARDWARE

Adapters

Mission-critical host connection and printer adapters for PCs and laptops.

Whether you need to link your desktop to a mainframe or AS/400,® Attachmate has a high-performance adapter to suit your needs. No company sells more 3270 emulation adapters and printer emulators than Attachmate, so count on us for immediate availability, top quality and service.

Select Attachmate hardware. Attachmate offers a complete line of adapters for Windows® PCs, laptops, and gateways. Choose from direct, asynchronous or synchronous connections to fit almost any architecture – including the industry-standard PCI (Peripheral Component Interconnect) architecture. Hardware for host information access includes:

- IRMA™ 3270 PCI adapter (page 2)
- IRMA 3® Convertible adapter (page 2)
- Advanced 3270 adapter (page 3)
- IRMA™ Pocket 3270 adapter (page 3)
- IRMA™ Twinax adapter (page 4)
- SDLC adapters (page 4)
- Intelligent SDLC adapters (page 4)
- Advanced ISCA™ Adapter (page 4)
- Enhanced Asynchronous SNA adapter (page 5)
- IRMATrac 16 Token Ring Adapters (page 6)

And for printer emulation:

- MainPrint CX adapter (page 6)
- IRMAprint™ adapter (page 6)

Use the chart below to determine which adapter best suits your needs. For additional information, refer to the individual descriptions inside this profile.

Hardware Roadmap

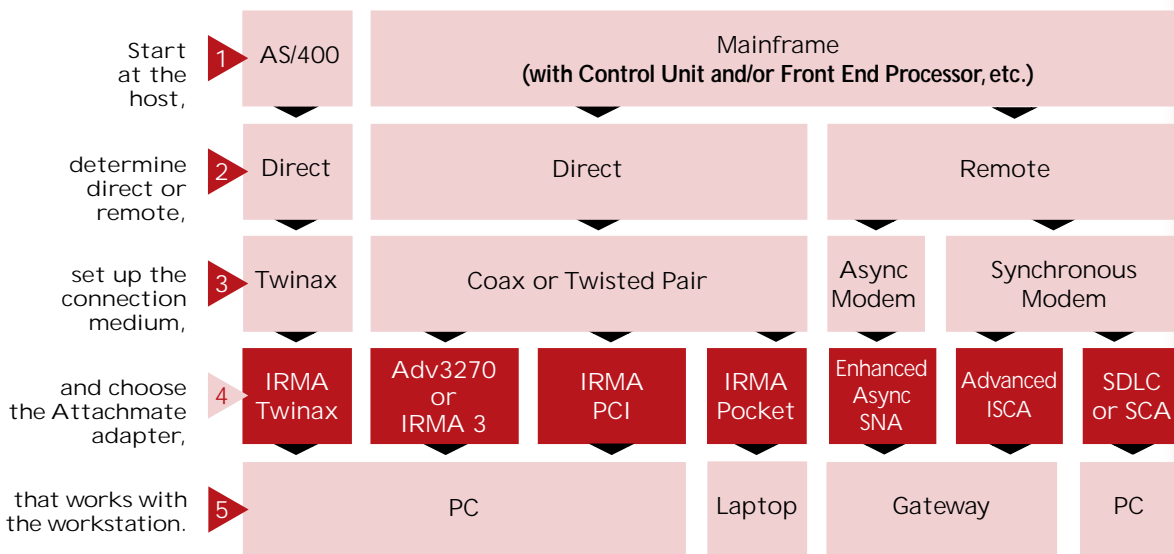

PRODUCT PROFILE

"We can think of exactly 3270 reasons that Attachmate's IRMA board, which connects PCs to mainframes, was an incredible success. (It) has to be the one product that symbolizes the acceptance of PCs by the corporate world."

BYTE

20th Anniversary Report

PC-to-IBM® mainframe, direct connect IRMA 3270 PCI Adapter

The 3270 adapter for Windows 95 and Windows NT.®

The IRMA 3270 PCI Adapter is the only adapter solution available today that supports 3270 terminal connectivity through the PCI (Peripheral Component Interconnect) interface, fully supporting the PCI V2.1 standard. This adapter works in the Intel® Pentium® X86 PCI computer platform.

Plug and play configurable.

The benefit of plug and play is that it automates adapter configuration. The IRMA 3270 PCI is the first true plug and play 3270 adapter to support Windows 95 and Windows NT. Utilizing PCI expansion slots, it allows Windows users to exploit PCI's capabilities for host access.

Cost-effective and flexible.

The IRMA 3270 PCI Adapter provides an on-board microprocessor, ROM microcode for easy upgrades, and built-in support for coax and UTP (twisted pair) cabling without the requirement of an external balun.

Supports the world's leading 16- and 32-bit connectivity software.

The IRMA 3270 PCI Adapter is compatible with Attachmate's EXTRA! and IRMA software. It is available as a standalone hardware platform, or is bundled with the award-winning Attachmate EXTRA!® Office Client software for Windows, Windows 95 and Windows NT, for powerful PC-to-host connectivity. You get an unbeatable combination of PCI-powered integrated functionality with reliable, transparent mainframe access.

IRMA 3 Convertible Adapter

The most widely used 3270 emulation hardware adapter in the world.

The IRMA 3 Convertible's unique, patented dual bus design gives you a choice of PC architectures, 3270 emulation modes, and connection types. Because of its remarkable circuitry, you can simply plug it in one way for PC installations, or turn it upside down for PS/2.® IRMA 3 enables you to standardize on a single coaxial adapter for any 3270 terminal emulation.

Speed through functions.

The IRMA 3 Convertible fits in a half-card expansion slot and is based on the premier Divine II chip for ultimate speed and efficiency. The on-board, high-speed microprocessor manages the 3270 protocol independently of the PC processor. This lets your PC function as an on-line 3278/79 terminal and as a PC at the same time. You can take advantage of the display-and-send functions of the IBM terminals, as well as all the processing capabilities of a PC.

Connect via coax or twisted-pair cabling. The IRMA 3 Convertible allows direct attachment via coaxial or twisted-pair cabling. Twisted-pair connections require no external balun.

Choose single or multi-session emulation. The IRMA 3 Convertible supports both CUT and DFT emulation modes. So you can choose single session emulation through a control unit terminal (CUT) controller, or multi-session emulation through a distributed function terminal (DFT) controller.

Use Attachmate or IBM software. IRMA 3 Convertible adapters let you choose either Attachmate EXTRA! or IRMA, or IBM PC-to-host access software. The wide range of supported software allows you to upgrade or change your emulation software without swapping out the hardware.

Upgrade easily.

Software-loaded microcode makes for easy upgrades. When you receive IRMA 3 Convertible upgrades, simply install the new programs directly from the diskette. IRMA 3 Convertible frees you from manually changing PROMs or returning hardware.

Thanks to full Plug and Play and PCI v2.1 compliance, the IRMA 3270 PCI Adapter automatically configures itself to PCI-based Windows 95 and Windows NT PCs.

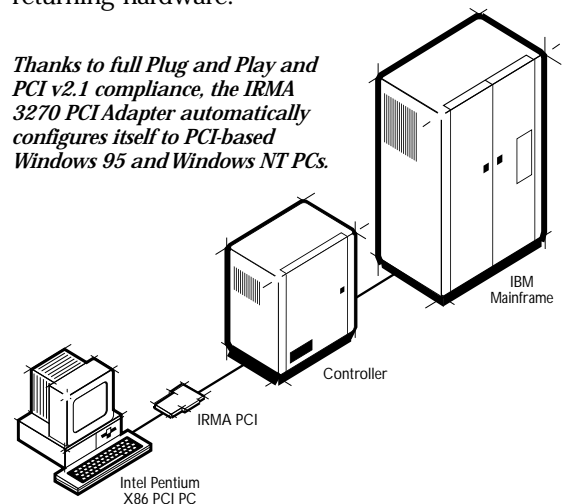

Advanced 3270 Adapter

A reliable link between a PC and an IBM mainframe.

The direct connection made by the Advanced 3270 Adapter is less likely to encounter downtime than LAN-based software emulation.

The Advanced 3270 Adapter features Attachmate's powerful 3270 integrated circuit processor. It reduces the number of individual components to deliver better reliability.

Automatic software detection. Choose Attachmate's EXTRA! or IRMA PC-to-host information access software to use with the Advanced 3270 Adapter. The Advanced 3270 Adapter default configuration *automatically* detects the type of software being used so you don't have to change any hardware settings.

Connect via coax or twisted-pair cabling. The Advanced 3270 Adapter allows direct attachment via coaxial or twisted-pair cabling. Twisted-pair connections require no external balun.

Link a PC to a mainframe using the Advanced 3270 Adapter.

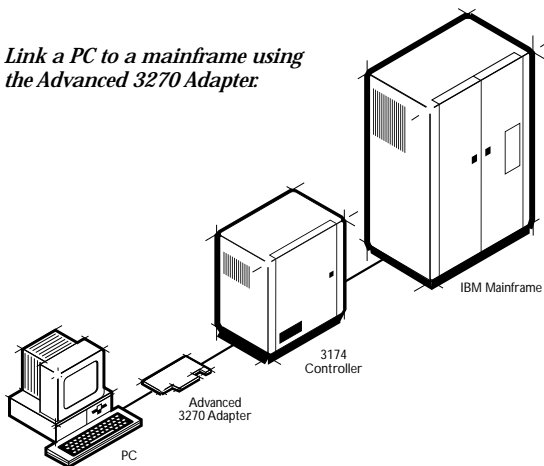

Laptop-to-IBM mainframe, direct connect

IRMA Pocket Adapter

Access tons of information with a three-ounce adapter.

Easily connect a laptop or desktop PC to an IBM mainframe with the IRMA Pocket adapter. It's small enough to fit in the palm of your hand, yet it gives you the flexibility to download mainframe files to your laptop and take your work home with you. It's powerful, too, driven by an on-board RISC processor.

Install in minutes.

IRMA Pocket adapter attaches to your PC's parallel port and connects to the mainframe with coaxial cable or twisted-pair cable. By using the parallel port, IRMA Pocket does not take up any valuable PCMCIA expansion slots. It includes a comprehensive software diagnostics program with a pull-down menu and its own diagnostic software, to test your installation at any time.

IRMA Pocket lets you easily connect a laptop, notebook, portable, or even a desktop PC to an IBM mainframe.

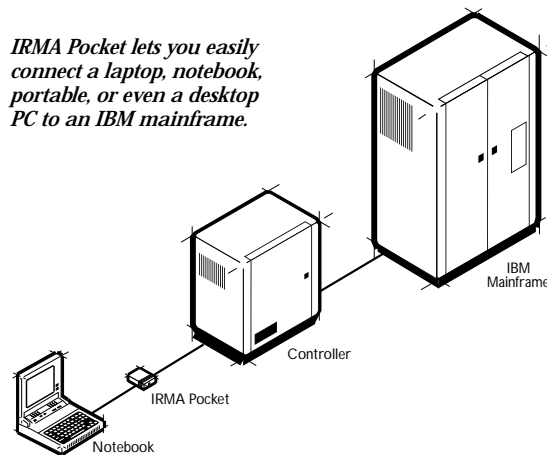

Maintain a session without power.

IRMA Pocket's external power supply maintains your session even when your laptop "sleep" feature engages to conserve precious battery power.

Works with Attachmate software.

IRMA Pocket adapter works seamlessly with Attachmate's EXTRA! 16-bit and IRMA connectivity software. Take full advantage of Attachmate's great information access features, such as multiple connectivity options and speedy file transfer.

Enhanced Parallel Port (EPP) specification

If your PC has an EPP parallel port, IRMA Pocket performs like an adapter in an Industry Standard Architecture (ISA) PC 8-bit slot. If your PC parallel port doesn't support EPP, don't worry. IRMA Pocket automatically adjusts to give you the best performance possible.

Choosing a synchronous adapter

To choose a synchronous adapter, first decide whether you wish to connect a server or standalone PC. Next, select the right host access or gateway software from the handy grid on page 7. In light of all the potential options, it's clear that Attachmate offers a wide enough range of solutions to meet your organization's unique needs.

PC-to-AS/400, direct connect ***IRMA Twinax Adapter***

Easy 5250 connectivity from your PC to an AS/400.

The IRMA Twinax Adapter provides a reliable and secure connection between a PC and an AS/400. It provides a cost-effective solution for 5250 applications.

Use any Attachmate or IBM AS/400 software.

The IRMA Twinax Adapter works with Attachmate's RALLY!® for AS/400, IBM's PC-to-AS/400 host access software, and other industry-leading software packages. The IRMA Twinax is 100% IBM register-level compatible.

The IRMA Twinax Adapter also comes with IBM-compatible adapter handler drivers for easy installation in the AS/400 environment.

The adapter is supplied with a self-terminating Twinax cable so you don't have the expense of buying a cable separately.

PC-to-IBM mainframe, standalone remote synchronous ***SDLC Adapters***

The economical alternative for SNA access. SDLC adapters are an economical alternative for connecting an IBM mainframe to a standalone PC. You can use these adapters with an RS-232 connection and your synchronous modem to achieve data rates of up to 19.2Kbps for remote SNA access.

Synchronous Communications Adapter (SCA)

For IRMA host access software use the Synchronous Communications Adapter (SCA).

Synchronous Data Link Control (SDLC) adapter

For EXTRA! host access software use the Synchronous Data Link Control (SDLC) adapter.

The IRMA Twinax Adapter lets you easily connect a desktop PC to an IBM AS/400.

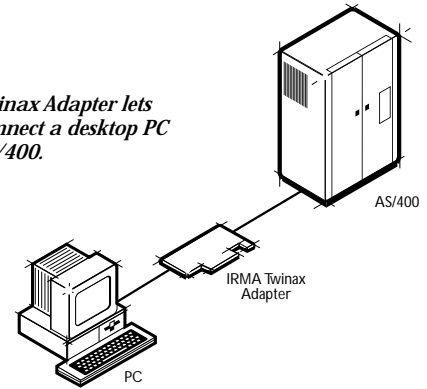

Gateway-to-IBM mainframe, remote synchronous ***Intelligent SDLC Adapters***

Now offering *three* solutions featuring the new higher-performance Advanced ISCA Adapter.

Now Attachmate offers *three* solutions for intelligent SDLC adapters – the trusty ISCA and Advanced Function adapters and the new higher-performance Advanced ISCA Adapter. We've retained the ISCA and Advanced Function adapters for enterprises that have standardized on their reliable performance and compatibility with existing software solutions. But for customers who are migrating to more robust software solutions that can accommodate faster connections and better overall performance, we've added the Advanced ISCA Adapter to the product line.

Advanced ISCA Adapter – faster and more compatible than ever.

Attachmate combined the features of the Advanced Function *and* Intelligent Synchronous Communications (ISCA) Adapters and enhanced those features resulting in the new Advanced ISCA Adapter. It offers improvements in key areas such as speed, increased bandwidth, compatibility and ease of installation, making it a reliable, high-performance bridge between your mission-critical enterprise host and remote LAN via synchronous connection.

Send host information securely to your remote LAN at up to 512 Kbps. New, more robust hardware specifications built in to the Advanced ISCA Adapter accelerate communications traffic and on-board processing. Thanks to a wider-bandwidth 16-bit bus interface, faster HD-26 connector and 512 Kbps line data rate, the data stream moves down the pipe with significantly increased speed. There's potential for even greater speed increases due to Windows NT Symmetrical Multiprocessing (SMP) support. On top of speed, the Advanced ISCA Adapter delivers reliable data security. Bottom line: your remote LAN gets mission-critical mainframe information faster and with the utmost security, empowering users on that LAN toward increased productivity.

Alignment with new standards encourages compatibility and eases installation.

The Advanced ISCA Adapter's adoption of the Plug and Play standard, as defined by Microsoft – on top of enhanced IRQ support – virtually eliminates the potential for configuration hassles and troublesome IRQ conflicts. Plus, new support for the X.21 line interface, in addition to existing support for RS232 and V.35, adds to the Advanced ISCA Adapter's compatibility. On-board auto-sense interface intelligence, hard-wired into the board, automatically selects the appropriate line interface making installation a snap.

Supporting all industry-leading server software – including Microsoft SNA Server and Novell NetWare for SAA Server. With the Advanced ISCA Adapter, you select the server – including Microsoft SNA Server, Novell® NetWare® for SAA® Server and select Attachmate servers. Teamed with Attachmate's award-winning family of EXTRA! host connectivity software, you get a total hardware and software solution backed by renowned Attachmate connectivity expertise and customer support.

Aggressive trade-up pricing fits neatly into your enterprise IT budget. Aggressive trade-up pricing makes it attractive to upgrade to the Advanced ISCA Adapter and realize a significant increase in speed, plug and play installation, enhanced compatibility and standards support and, ultimately, a boost in end-user productivity.

Advanced ISCA Adapter

Supports:

- Microsoft® SNA Server SDLC
- Microsoft SNA Server X.25
- Microsoft SNA Server XID 3
- Novell NetWare for SAA Gateway SDLC
- Novell NetWare for SAA Gateway X.25

Intelligent Synchronous Communications Adapter (ISCA)

Supports:

- Microsoft SNA Server for Windows NT
- Novell NetWare for SAA
- Attachmate ZIP!® SNA Server
- Banyan® VINES® Comm Gateway for 3270
- Banyan SNA Communications Server

Advanced Function SDLC Adapter (Synchronous Data Link Control)

Supports:

- Microsoft SNA Server for Windows NT
- Attachmate ZIP! SNA Server
- RALLY! Server for AS/400

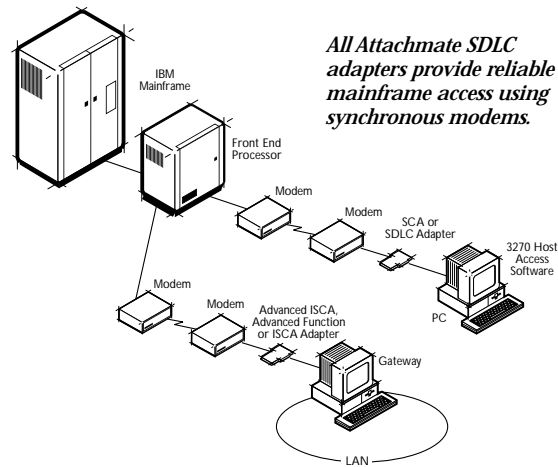

Gateway-to-IBM mainframe, remote asynchronous

Enhanced Asynchronous SNA Adapter

For high-speed, dial-in mainframe access. The eight-port Enhanced Asynchronous SNA Adapter provides high-speed dial-in mainframe access using standard Hayes®-type asynchronous modems and EXTRA! host access software. When dialing into a gateway PC equipped with an Attachmate asynchronous adapter, the remote PC acts exactly as if it were equipped with an SNA/SDLC adapter and a synchronous modem.

“Reliable access to host data by users in 117 locations throughout the state is very important to us. Using about 1,000 Attachmate hardware adapters, we’ve had secure, reliable connectivity that we can count on.”

Manny Adame

Information Systems Analyst

State of California,

Department of Rehabilitation

3270 printer emulation

For printing your mission-critical applications at the desktop, MainPrint CX is the right solution.

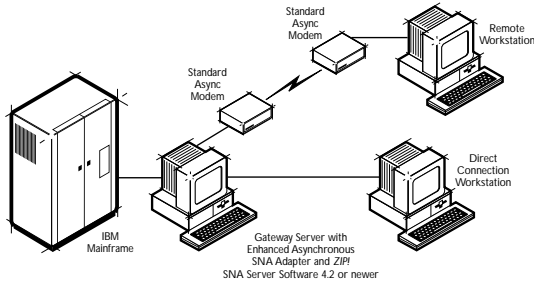

Use the Enhanced Asynchronous SNA Adapter to make remote or direct connections without special SDLC adapters or synchronous modems.

The enhanced model supports data rates of up to 28.8Kbps on all eight ports and supports up to four adapters in a single PC, making 32 concurrent mainframe connections possible.

All Attachmate asynchronous adapters use native IBM-compatible SNA protocols to preserve data integrity and security. All 3270 functions are available: printing, graphics and applications.

IrmaTrac 16 Token Ring Adapters

Attachmate also offers a full line of 4/16 token ring adapter solutions from Microdyne, including:

- IrmaTrac Convertible
- IrmaTrac HardTop
- MacIrmaTrac NuBus 4/16 Token Ring Adapter
- IrmaTrac PNP 4/16
- IrmaTrac PCI 4/16
- IrmaTrac 4/16 PCI Server Adapter

For more information, visit Microdyne's Web site at www.mcdy.com or call Microdyne at 1-800-255-3967.

You can share a PC printer among many devices using MainPrint CX.

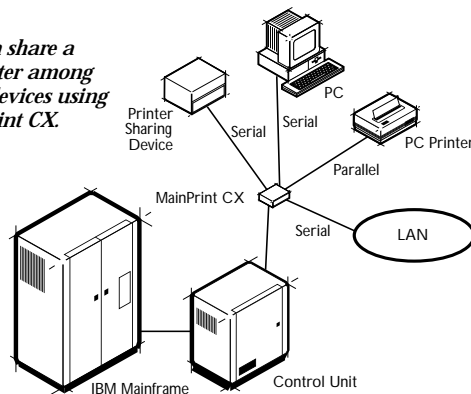

3270 printer emulation for PC printers **MainPrint CX**

The versatile adapter for 3270 printer emulation.

MainPrint CX emulates IBM 3287, 3262, 3268 and 4224 (non-IPDS) system printers on high-quality impact and laser PC printers. Using MainPrint CX with a PC printer can save 70% of the cost of an IBM system printer. And the lower maintenance cost of a PC printer will continue to bear savings versus the higher maintenance expenses of an IBM system printer.

Take advantage of PC printer features such as custom fonts, bold and italics, bar codes and graphics. Plus, using host software packages such as GRAF-ACX, you can print GDDM host graphics.

Share the printer seamlessly.

MainPrint CX's intelligent printer sharing feature lets you automatically switch between PC and mainframe print sessions. By connecting MainPrint CX to a printer sharing device or local area network, your workgroup can print both PC and 3270 documents on a single PC printer.

Serial and parallel connections in a single unit.

MainPrint CX is so compact that you can mount one on every printer without infringing upon valuable workspace. Simply connect the coax, parallel, and serial-plus ports to their respective devices. When it's time to upgrade MainPrint CX, just download the new files from your PC. No need to swap out EPROMs.

Quickly set parameters.

Simply type commands on your PC and send them to MainPrint CX via a screen print or text file. You can adjust paper size, orientation, lines per inch and pitch – even your character set.

IRMAprint

The quickest way to connect parallel or serial printers in a 3270 network. IRMAprint enables you to use a laser, line, letter quality or dot matrix printer in an IBM 3270 network. Plug in IRMAprint to instantly make any parallel or serial printer appear to the 3270 terminal controller as an IBM 3287 printer, compatible with IBM system software.

Install at the controller site.
Simply attach the coaxial cable from the 3270 controller to the connector on the rear panel of IRMAprint. Choose the serial or parallel version of IRMAprint to match your printer configuration.

When you attach an IBM 3278 or 3279 terminal or a PC with an IRMA board to IRMAprint's coax port, you can configure your printer on-screen. Quickly select asynchronous interface parameters such as baud rate, parity, and hand-shake protocol. You can also indicate alternate character conversion mappings to meet special needs. Configurations are permanently stored in non-volatile RAM until you reconfigure IRMAprint.

Manipulate printouts.
You can change fonts in selected words, underline a sentence, or print a paragraph in compressed print, depending on the capabilities of your printer. Don't worry about escape sequences every time you send a print job – IRMAprint takes care of them for you.

Verify functions.
IRMAprint generates print patterns to verify operation of the attached printer. It also verifies correct internal conditions upon power up.

Call today for more information about all Attachmate hardware adapters.
Attachmate is the leading supplier of universal information access software and connectivity adapters to large organizations. These products safely extend intranets by linking host systems, Internet systems and workgroups together. Award-winning Attachmate products offer solutions for multi-host application and database access, remote access, workgroup productivity, enterprise client/server development, network and software management and corporate-to-Internet systems integration.

For more information about Attachmate host information access and host printer emulation adapters, contact your local Attachmate reseller or call us toll-free in the United States or Canada at **800-426-6283**. For international sales information, call USA **425-644-4010** or contact your nearest sales office.

Now offering a three-year warranty.

Attachmate now offers an industry-leading three-year warranty with all hardware adapters – building on a tradition of unrivaled product support.

The right software for your Attachmate hardware adapter.

Software	3270 COAX				Twinax	SDLC					
	IRMA 3270 PCI	IRMA 3 Convertible	Advanced 3270	IRMA Pocket		IRMA Twinax	Enhanced Async SNA	SCA	SDLC	ISCA™	Adv ISCA
Attachmate® Host Access Software											
EXTRA!® Personal Client	•	•	•				•	•			
EXTRA! Office Client	•	•	•				•	•			
EXTRA! for Windows® 95/Windows NT®	•	•	•				•	•			
EXTRA! for Windows 16-bit	•	•	•	•				•			
EXTRA! Extended for DOS		•	•					•			•
IRMA™ Mainframe for Windows	•	•	•	•			•				
RALLY!® for AS/400					•			•			
Other Host Access Software											
IBM® (various brands)		•	•								
Attachmate Gateway Host Access Software											
ZIP!® SNA Server			•			•		•	•		•
EXTRA! Host Access Server											•
EXTRA! Host View Server											•
Other Gateway Software											
Novell® NetWare® for SAA®									•	•	
Microsoft® SNA Server for Windows NT		•	•		•			•	•	•	•
Banyan® VINES® Comm Gateway for 3270									•		
Banyan SNA Communications Server									•		

U.S. and Canadian Sales:
(800) 426-6283
(425) 644-4010
Fax: (425) 747-9924

Customer Support:
(425) 957-4607

FaxBack:
(425) 649-6595

World Wide Web:
www.attachmate.com

Australia (Melbourne)
(61) 39 694 6711

Australia (Sydney)
(61) 2 9975 7188

Belgium
(32) 2-481 07 50

Brazil
(55) 11 866 3766

Denmark
(45) 42 17 10 00

Finland
(358) 9 437 5236

France
(33) 1 4604 1010

Germany
(49) 89 99 351-0

Hong Kong
(852) 2 572-8988

Italy
(39) 2 6713101

Japan
(81) 3 5560 8970

Latin America
(305) 358 7830

Malaysia
(603) 245 5660

Mexico
(52) 5 208 0360

Netherlands
(31) 20 696 6031

Norway
(47) 22 91 06 00

Portugal
(351) 1 7928750

Singapore
(65) 223 0233

South Africa
(27)11 784 0414

Spain
(34) 1 300 86 00

Sweden
(46) 8 6307530

Switzerland (Zurich)
(41) 1 289 90 11

Switzerland (Geneva)
(41) 22 879 04 10

United Kingdom
(44) 1189 890 390

Features at a Glance

PC-to-IBM mainframe

IRMA 3270 PCI

- Utilizes PCI expansion slot
- Plug and play compliance to take full advantage of Windows 95 and Windows NT
- Coax and twisted pair cabling without the requirement of an external balun
- ROM microcode for easy upgrades
- Standalone, or bundled with EXTRA! Office Client for a total 16- and 32-bit solution in a single package
- Part # 124258

IRMA 3 Convertible

- Patented dual bus architecture fits any PC or Micro channel half card slot
- Coax and twisted pair connections for cost-effective cabling to an IBM controller (balun not required)
- CUT and DFT emulation modes with Attachmate, IBM and other host access software
- Software-loaded microcode for easy upgrades by diskette
- Onboard microprocessor for concurrent terminal and PC functionality
- Standalone or bundled with EXTRA! Office Client or IRMA for the Mainframe for Windows
- Part # 118876

Advanced 3270

- Coax and twisted pair connections for cost-effective cabling to an IBM controller
- CUT and DFT emulation modes with Attachmate, IBM and other host access software
- Dual Purpose Connector eliminates the need for an external balun when using twisted-pair cabling
- Automatic detection of Attachmate or IBM host access software so you don't have to change any hardware settings
- Standalone or bundled with EXTRA! Office Client or EXTRA! for Windows
- Part # 104680

Laptop-to-IBM mainframe

IRMA Pocket 3270

- Attaches directly into a parallel port with coax or twisted-pair cabling taking no PCMCIA expansion slots
- ISA PC slot performance with EPP parallel port – automatically adjusts for best performance without EPP
- Diagnostic software included so you can test your installation at any time
- External power to maintain session with battery power off
- High-performance RISC processor for fast mainframe connection
- Part # 119230

PC-to-AS/400

IRMA Twinax

- 100% IBM register-level compatible for complete IBM software compatibility (ISA version)
- IBM-compatible adapter handler drivers for easy installation in the AS/400 environment
- Self-terminating Twinax Y-cable to curb cabling expenses
- Supports Attachmate RALLY! for AS/400, IBM's AS/400 host access software, and other industry leading AS/400 host access software
- Standalone or bundled with RALLY!
- Part # 112330

PC-to-IBM mainframe, standalone remote synchronous

- Economical access to an SNA network with data rates of up to 19.2Kbps

SCA

- Works with IRMA software Part # 119229

SDLC

- Works with EXTRA! software Part # 106021

Gateway-to-IBM mainframe, remote synchronous Advanced ISCA Adapter

- Plug and Play – fully and automatically software configurable
- Faster throughput and processing
 - On-board 16-bit 20 Mhz processor
 - 512 Kbps line data rate
 - HD-26 connector
 - 16-bit bus interface
- Microsoft SNA Server for Windows NT and Novell NetWare for SAA Server support
- Windows NT Symmetrical Multiprocessing (SMP) support
- Enhanced IRQ support – 3,4,5,7,10,11,12 and 15
- Supports RS232,V.35 and X.21 line interfaces with on-board auto-sense interface intelligence
- Part # 129413

Advanced Function SDLC

- Onboard intelligence and memory for data rates up to 64Kbps
- Works with Attachmate's ZIP! SNA gateway and Microsoft SNA Server for NT
- XID3 support
- LU6.2 support
- Part # 104300

ISCA

- Onboard intelligence and memory for data rates up to 64Kbps
- Works with all Attachmate servers, Microsoft SNA Server for NT, NetWare for SAA, and Banyan VINES
- PPP over leased line
- Supports Novell Multiprotocol Router for PPP, Frame Relay and X.25
- Part # 119012

Gateway-to-IBM mainframe, remote asynchronous Enhanced Asynchronous SNA Adapter

- No special SDLC adapters or difficult-to-use synchronous modems needed to access a mainframe
- 8 ports, so 8 users can simultaneously access the host at data rates of 28.8 Kbps
- Up to four adapters can be installed in a single PC making 32 concurrent mainframe connections possible
- Enhanced Asynchronous SNA Adapters work with Attachmate's ZIP! SNA server
- Part # 115968

Printer emulation

MainPrint CX

- IBM 3287, 3262, 3268 and 4224 (non-IPDS) printer emulation
- Intelligent printer sharing lets you automatically switch between PC and mainframe print sessions
- Compact enough to mount on printer
- Enables PC printer features such as custom fonts, bold and italics, bar codes and graphics
- Host software packages such as GRAF-ACX to print GDDM host graphics supported
- To upgrade MainPrint CX, just download the new files from your PC; there's no need to swap out EPROMs
- Part # 119233

IRMAprint

- Onscreen configuration when you attach an IBM 3278/3279 terminal or a PC with an IRMA board to IRMAprint's coax port
- Automatic escape sequence entry every time you send a print job
- Self-verification of operation and correct internal conditions upon power up
- Standard RS-232C interface or a Centronics parallel interface to fit most set-ups
- Character translations in LU1 and LU3 modes for multinational use
- Part # 119214

If you require additional technical specifications, please dial Attachmate FaxBack® at 425-649-6595.

 **Attachmate**
Attachmate Corporation
3617 131st Ave SE
Bellevue, WA 98006 USA

© 1997 Attachmate Corporation. All Rights Reserved. Printed in the U.S.A. Attachmate, EXTRA!, IRMA 3, RALLY! and ZIP! are registered trademarks and IRMA, IRMAprint, and ISCA are trademarks of Attachmate Corporation. Microsoft, Windows and Windows NT are registered trademarks of Microsoft Corporation. IBM, AS/400, SAA and PS/2 are registered trademarks of International Business Machines Corporation. FaxBack is a registered trademark of FaxBack, Inc. Novell and NetWare are registered trademarks of Novell, Inc. Banyan and VINES are registered trademarks of Banyan Systems, Incorporated. Hayes is a registered trademark of Hayes Microcomputer Products, Inc. Intel and Pentium are registered trademarks of Intel Corporation. All other trademarks and registered trademarks are the property of their respective owners.