

Z60t series Setup Poster

P/N 39T2154

07/27/2005

Size : 11x14 inches

Color : 2 color job = Process Black (This plate must be printed in PMS Process Black C)

Process Magenta (This plate must be printed in PMS 032cvc)

Font : IBM Fonts and Helvetica Neue Family

Material : 100 gsm gloss art paper (Use 100% recycled paper in only Japan.)

Blue line shows die-cut. DO NOT PRINT.

Please change the barcode No.

Please change the country name if the poster is printed in other than China.

ThinkPad

Initial Setup Instructions

For more detailed information, press the ThinkVantage button.



1 Unpack:

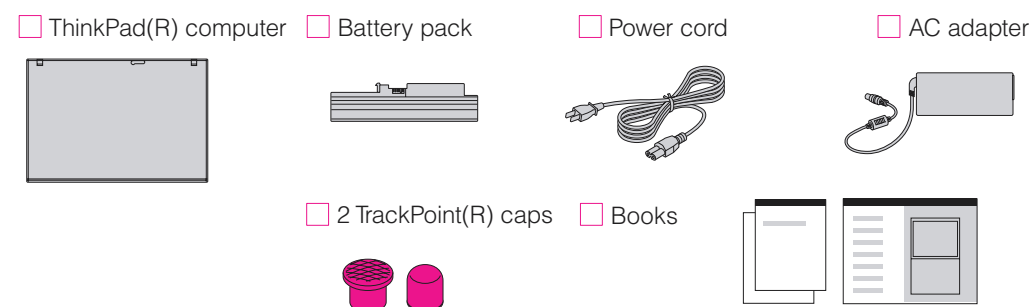

* See reverse for notes about unlisted, missing, or damaged items and recovery CD.

Note: Read the safety notices in the Service and Troubleshooting Guide before you use the computer.

- Setup Instructions (this sheet)
- Service and Troubleshooting Guide
- Other supplements or flyers

2 Install battery pack:

Your battery is ready to use.

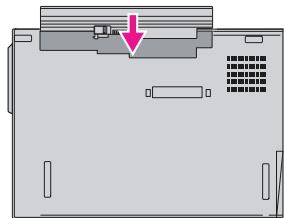

3 Connect to power:

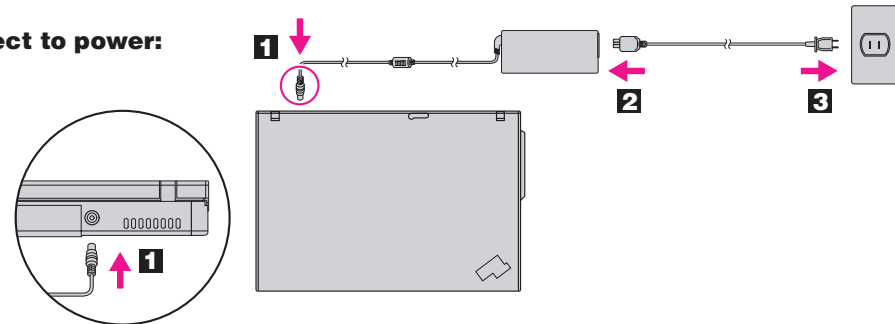

4 Turn on the power:

5 Point and click with UltraNav(TM) Multi-pointing Navigation System:

Press the TrackPoint cap or move across the touch pad in the direction you want to move the pointer. The left and right buttons below the space bar and touch pad function like mouse buttons. Some models may have only a TrackPoint.

6 Configure the Operating System following on-screen instructions:

This process takes several minutes, and your computer may restart multiple times.

7 To learn more, press the ThinkVantage button:



ThinkVantageDesign

1 UltraConnect(TM) wireless LAN antenna

2 ThinkLight(R) keyboard light

3 One - handed latch

4 Wireless WAN antenna*

*Specific models only.

5 Volume and mute buttons



6 Power button



7 ThinkVantage button



8 Web browser back and forward



9 Fingerprint reader*

*Specific models only.

10 TrackPoint center button

11 Fn key

Use in combination with other keys to access special ThinkPad features

	Lock your computer		Enter hibernation
	Manage battery & power		ThinkLight on/off
	Enter suspend		Multimedia controls
	Manage network connections		Change display brightness
	Change display settings		Magnify screen contents
	Change input device settings		
	Manage external devices		

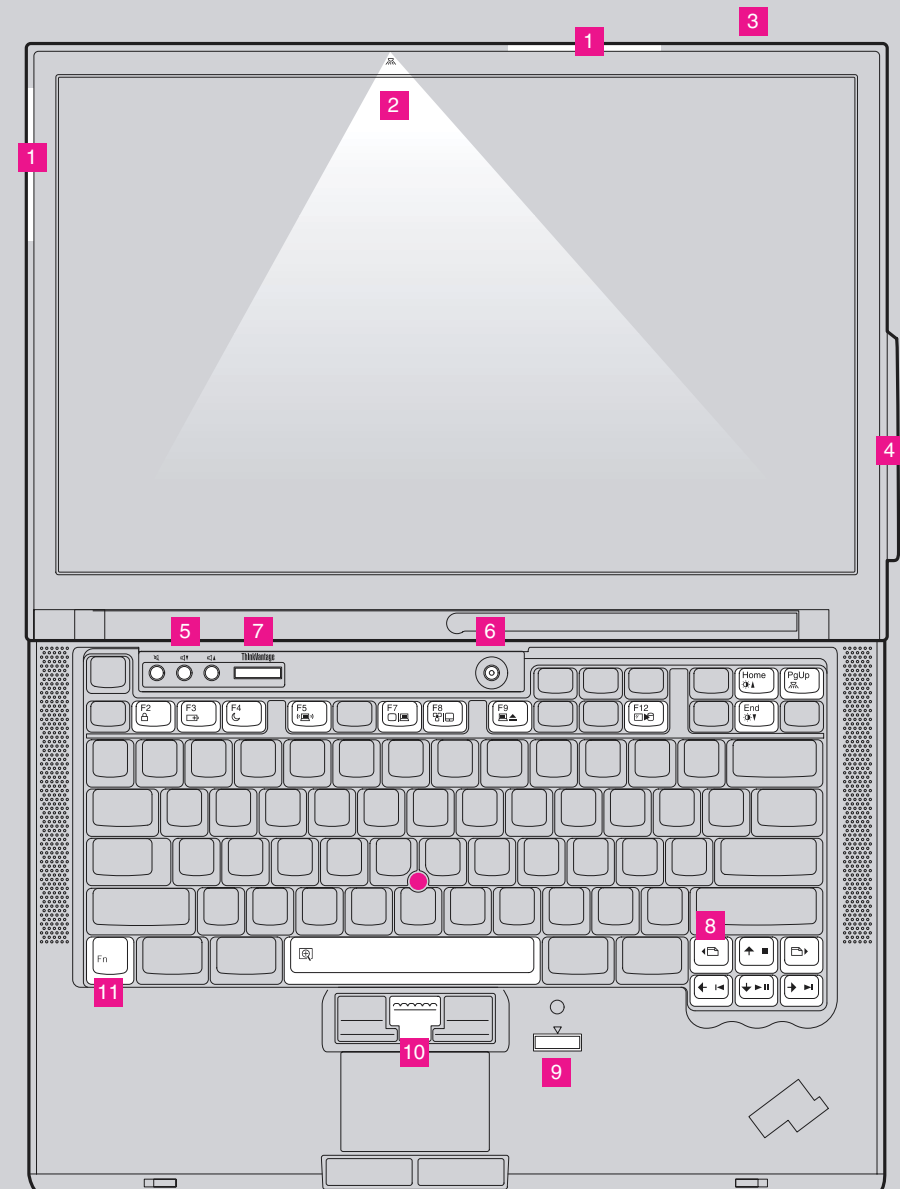

P/N: 39T2154

Z60t series Setup Poster

P/N 39T2154

07/27/2005

Size : 11x14 inches

Color : 1 color job = Process Black (This plate must be printed in PMS Process Black C)

Font : IBM Fonts and Helvetica Neue Family

Material : 100 gsm gloss art paper (Use 100% recycled paper in only Japan.)

Blue line shows die-cut. DO NOT PRINT.

Please change the barcode No.

Please change the country name if the poster is printed in other than China.

Installing Optional memory

You can increase the amount of memory in your computer.

Note: Only use memory types supported by your computer. If you incorrectly install the optional memory or install an unsupported memory type, a warning beep will sound when you try to start the computer.

1 Install the optional SO-DIMM:

1 Touch a grounded metal object to reduce any static electricity in your body that could damage the SO-DIMM. Avoid touching the contact edge of the SO-DIMM.

2 Turn off the computer.

3 Disconnect the ac adapter and all cables from the computer.

4 Close the computer display and turn the computer over.

5 Remove the battery.

6 Remove the 4 screws.

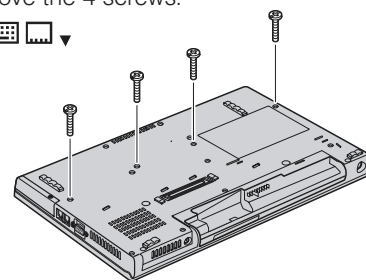

7 Turn the computer over again and remove the palmrest. It is not necessary to disconnect the cable trackpad cable.

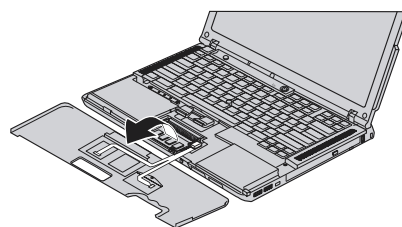

8 If a SO-DIMM is already installed, remove it as shown. Save the SO-DIMM for future use.

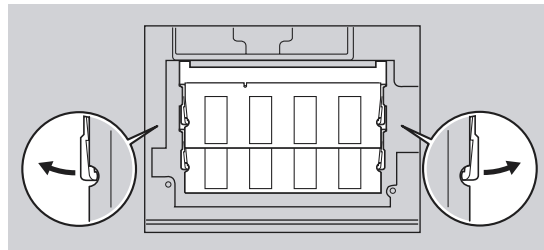

9 Align the notch in the contact edge of the SO-DIMM with the divider in the socket. Firmly insert the SO-DIMM into the socket at an angle of 20 degrees **1**, and then pivot it downward until it snaps into place **2**.

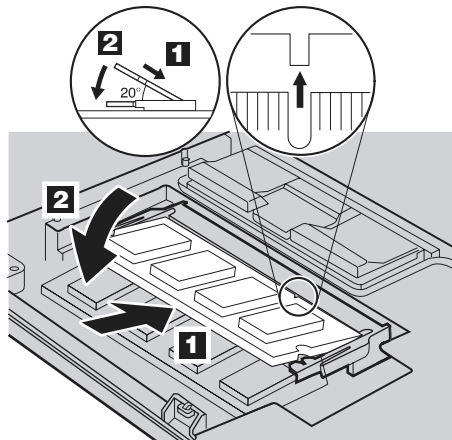

10 Replace the palmrest.

11 Turn the computer over and replace the 4 screws.

12 Replace the battery.

2 Verify proper installation of the optional SO-DIMM:

1 Turn on the computer.

2 Press the ThinkVantage button when prompted during startup.

3 Open the BIOS Setup Utility by clicking "Access BIOS" under the "Configure" category.

4 Verify that the "Installed memory" item shows the total amount of memory installed in your computer. For example, if your computer had 256 MB of standard memory and you install an additional 512 MB SO-DIMM, the quantity shown in "Installed memory" should be 768 MB.

ThinkVantageTechnologies

Pressing the ThinkVantage button on your keyboard opens the ThinkVantage Productivity Center.

ThinkVantage



To learn more about ThinkVantage Technologies and other topics, open Access Help from the Productivity Center menu and enter a topic in the index or Search keyword fields.



Productivity Center



Access Connections



Security



Rescue and Recovery



System Migration Assistant



System Update

* Additional unpacking notes:

1) Some models may contain items that are not listed.

2) If any item is missing or damaged, please contact your place of purchase

3) Your computer features Disk-to-Disk Recovery. Everything for recovering factory-installed files and applications is on your hard disk eliminating the need for a recovery CD. For more information, see "Recovering Pre-Installed Software" in the Service and Troubleshooting Guide.

Your name: _____

Company name: _____

Model number: _____

Serial number: _____

Company or reseller service: _____

Support Web site: _____

Support number: _____

© Copyright Lenovo 2005.

Portions © Copyright International Business Machines Corporation 2005.
All rights reserved.

ThinkPad is a registered trademark of Lenovo.
IBM is a trademark of IBM Corp.

Printed in China

For Barcode Position Only